

MatriX STAPES PROSTHESIS

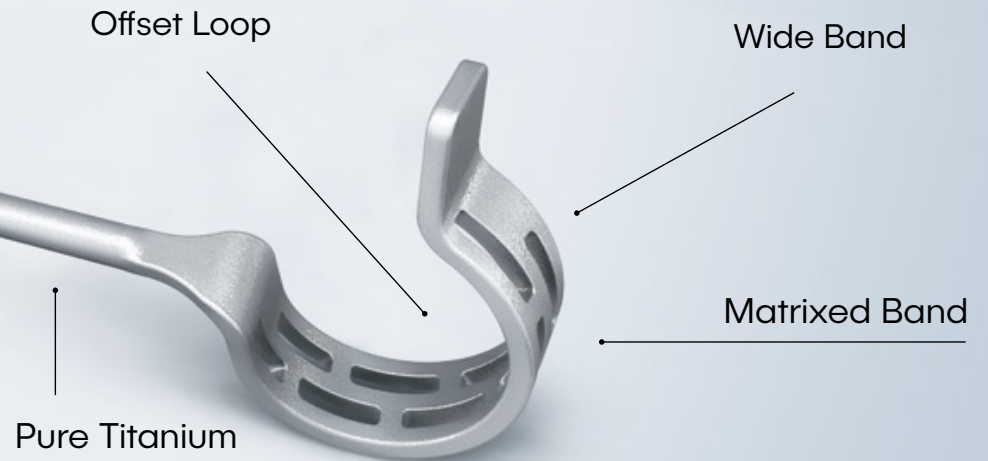

MIDDLE EAR INTELLIGENCE

- » Significantly reduced crimping force for safer crimping process
- » Wide band for optimized crimping control
- » Matrixed band provides conformed contact area to the incus
- » All titanium design for long time reliability

MatriX STAPES PROSTHESIS



MRI information:
www.kurzmed.com

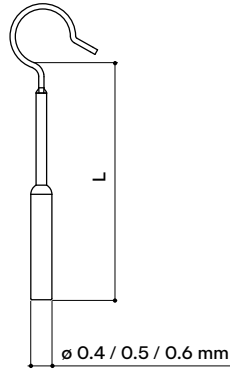

MatriX Stapes Prosthesis
Material: Pure Titanium
(ASTM F67
Medical Grade)
Diameter: 0.4/0.5/0.6 mm
Band loop width: 0.5 mm

LENGTH L (mm) Ø 0.4 mm	REF
3.50	1006 003
3.75	1006 004
4.00	1006 005
4.25	1006 006
4.50	1006 007
4.75	1006 008
5.00	1006 009
5.25	1006 010
5.50	1006 011

LENGTH L (mm) Ø 0.5 mm	REF
3.50	1006 023
3.75	1006 024
4.00	1006 025
4.25	1006 026
4.50	1006 027
4.75	1006 028
5.00	1006 029
5.25	1006 030
5.50	1006 031

LENGTH L (mm) Ø 0.6 mm	REF
3.50	1006 043
3.75	1006 044
4.00	1006 045
4.25	1006 046
4.50	1006 047
4.75	1006 048
5.00	1006 049
5.25	1006 050
5.50	1006 051

Developed in close collaboration with Jack Kartush, MD,
Michigan Ear Institute, Bloomfield, MI, USA.

Heinz Kurz GmbH Medizintechnik | Tuebinger Strasse 3
72144 Dusslingen | Germany | Phone: +49 (0)7072/9179-0
E-Mail: info@kurzmed.de | www.kurzmed.com

KURZ Medical, Inc. | 5126 South Royal Atlanta Drive Tucker,
GA 30084 | USA Toll Free Order #: 866.449.8020 | Phone:
770.349.6330 | E-Mail: info@kurzmed.com | www.kurzmed.com

CE 0124

07/2017-M9600361

Prescription Devices

Caution: United States Federal Law restricts devices identified herein to sale by or on the order of a physician. This brochure does not replace nor does it set forth the complete contents of the "Instructions for Use" for the products in this brochure, and is not a substitute for reviewing and understanding that important information. Therefore, before using any products included in this brochure, please review the entire contents of the respective "Instructions for Use" information.

Because of registration the products are currently not available in all countries.



MIDDLE EAR INTELLIGENCE